

# KG series

Power rocker switches



## DISTINCTIVE FEATURES

- Protected rocker
- Illuminated or non-illuminated
- Sealed to IP65



## ENVIRONMENTAL SPECIFICATIONS

- Degree of protection : IP65 according to IEC 60529
- Shock resistance : 100 g according to IEC 512-4, test 6c
- Vibration resistance : 10-500 Hz - 10 g according to IEC 512-4, test 6d
- Salt spray resistance : 96 hours according to IEC 512-6, test 11f
- Operating temperature :
  - 2 position models : -40 °C to + 85 °C (-40 °F to +185 °F)
  - 3 position models : -10 °C to + 65 °C (-14 °F to +149 °F)



## ELECTRICAL AND GENERAL SPECIFICATIONS

- Current/voltage rating :
  - functions 1 (ON-OFF) and 6 (ON-ON) : 15 A 12 VDC, 10 A 24 VDC max., 10 mA 14 VDC min.
  - functions 4 ( ON ON ON) and 4-1R (ON ON MOM) : 8 A 12 VDC, 5 A 24 VDC max.
  - other functions : 10 A 12 VDC, 8 A 24 VDC max.
- Initial contact resistance : 10 mΩ max. at 1 A 2 VDC
- Insulation resistance : 1,000 MΩ min. at 500 VDC
- Dielectric strength : 2,000 Vrms 50 Hz min. between terminals
- Electrical life : 10,000 cycles min.
- Mechanical life : 2 position models : 100,000 cycles min.  
3 position models : 30,000 cycles min.
- Panel cut-out : 36.80 x 21.08 mm (1.149 x .830)
- Panel thickness : 0.8 mm to 4.6 mm
- Recommended thickness : between 2 mm and 3.5 mm

The company reserves the right to change specifications without notice.

4006-022-002

shunto@126.com



# KG series

Power rocker switches



## MATERIALS

- Case : thermoplastic UL94-V0
- Terminals : brass, silver plated
- Contacts : silver grain
- Contact roller : brass, nickel plated



## ELECTRICAL FUNCTIONS

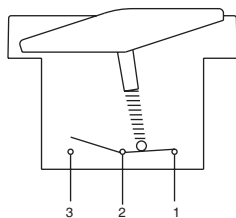

## PANEL CUT-OUT

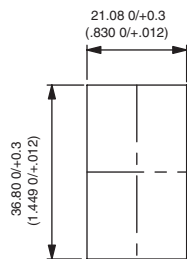

## MATRIX MOUNTING

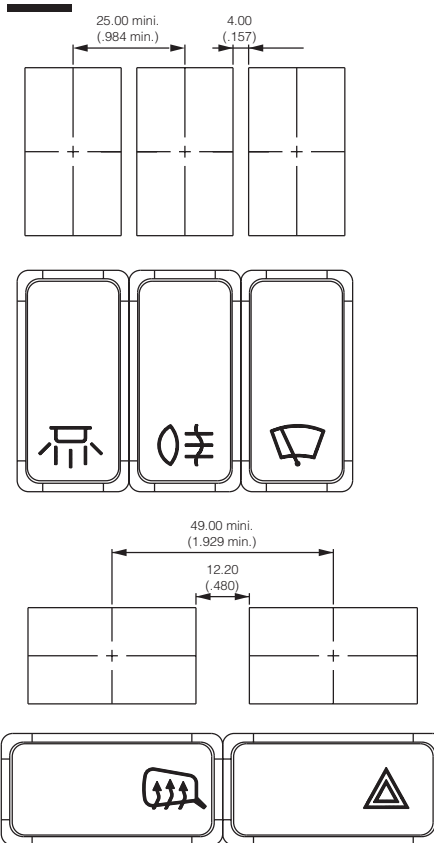

## TERMINALS

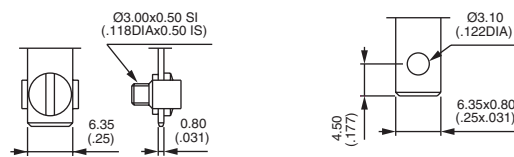

Screw

Solder lug / quick-connect

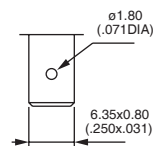

Normalized quick-connect 6.35x0.8

# KG series

Power rocker switches

## BUILD YOUR PART NUMBER

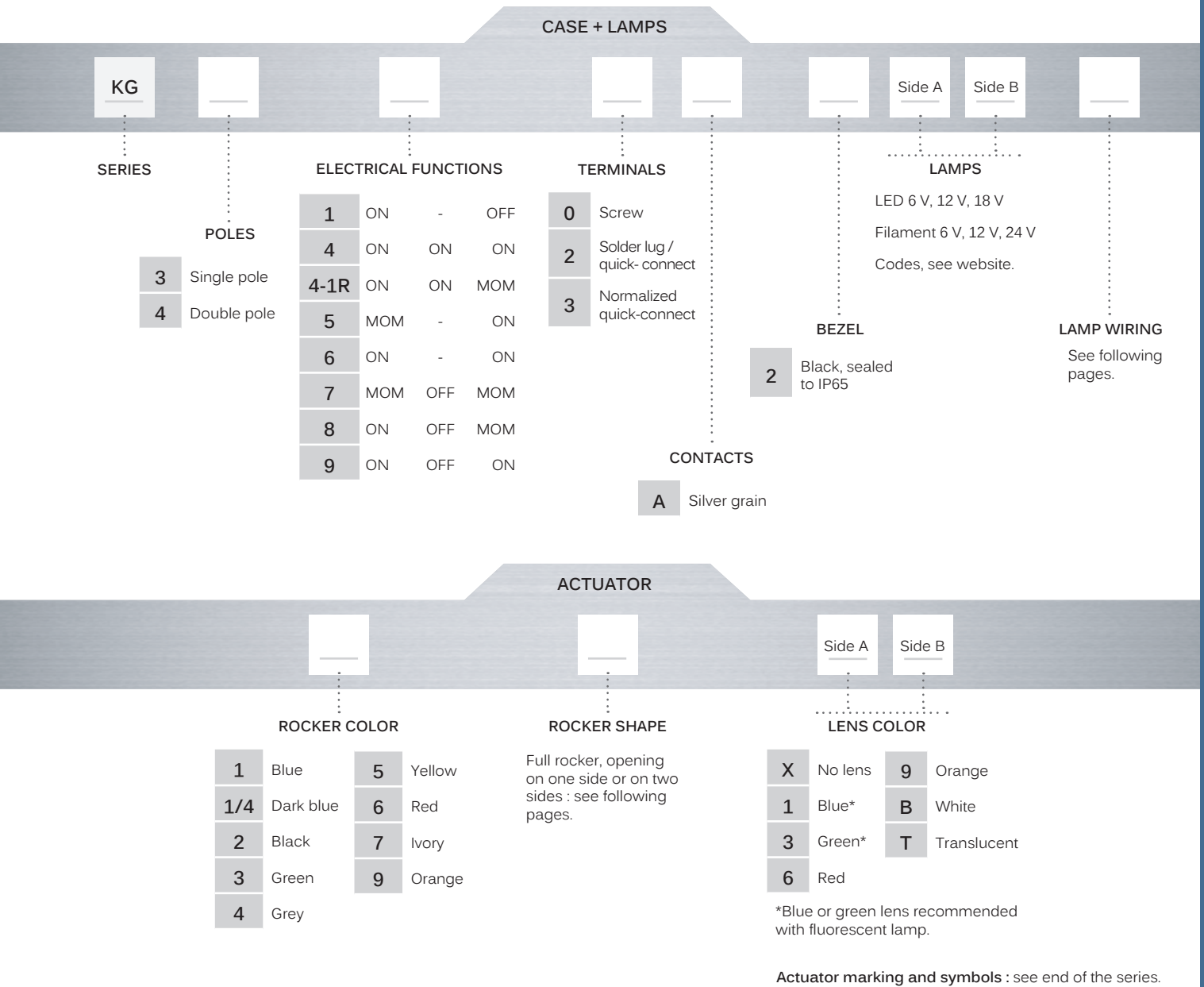

## ABOUT THIS SERIES

- ⚠ **Notice** : please note that not all combinations of above numbers are available. Refer to the following pages for further information.
- 🔒 **Sealing boot** are available to protect the switches against dust and water. See "Sealing Boots" section of website.

4006-022-002

shunto@126.com

# KG series

Power rocker switches

## SOLDER LUG / QUICK-CONNECT TERMINALS



Single pole	Double pole	2-3	5-6	1-2	4-5
KG31	KG41	ON	-	OFF	
	KG44*	ON	ON	ON	
	KG44-1R*	ON	ON	MOM	
	KG45*	MOM	-	ON	
KG36	KG46	ON	-	ON	
KG37	KG47	MOM	OFF	MOM	
KG38	KG48	ON	OFF	MOM	
KG39	KG49	ON	OFF	ON	

\* Function 4 & 5 : single pole in double pole case

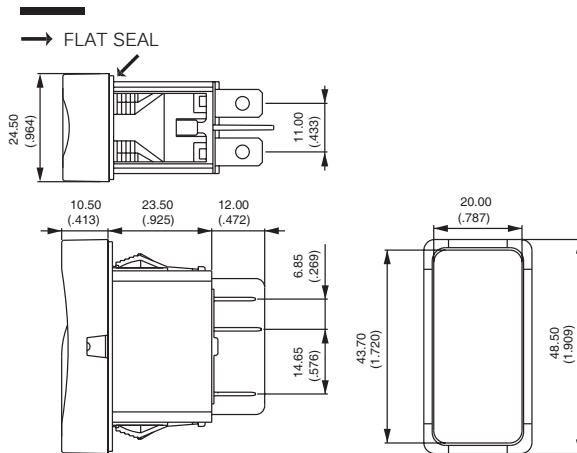

## CASE + LAMPS

## TERMINALS

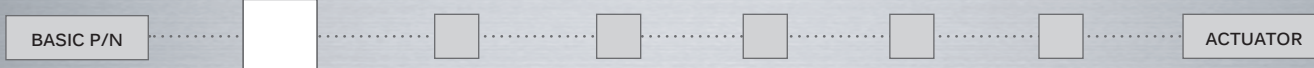

- 0 Screw
- 2 Solder lug / quick-connect
- 3 Normalized quick-connect

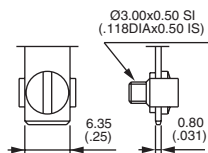

0

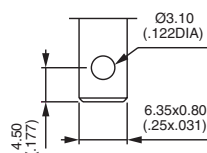

2

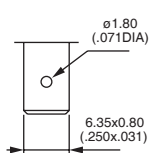

3

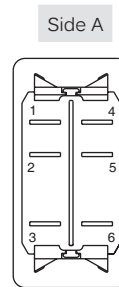

Side A

Side B

Terminals 1 to 6 are marked on the case.  
Side A : terminals 1 and 4  
Side B : terminals 3 and 6

## CASE + LAMPS

## CONTACT MATERIALS

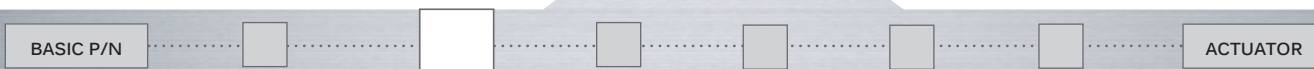

- A Silver grain

## CASE + LAMPS

## BEZEL



- 2 Black, sealed to IP65

# KG series

Power rocker switches

### CASE + LAMPS



Complete each enlarged box with one of the codes listed below.

- X Without LED
- O Filament 6 V
- P Filament 12 V
- R Filament 24 V

	Red	Green	Yellow	Blue	White
6 VDC	A	B	C	1	W
12 VDC	D	E	F	Z	V
18 VDC	G	H	I	-	-
24 VDC	J	K	L	Y	U

Side A

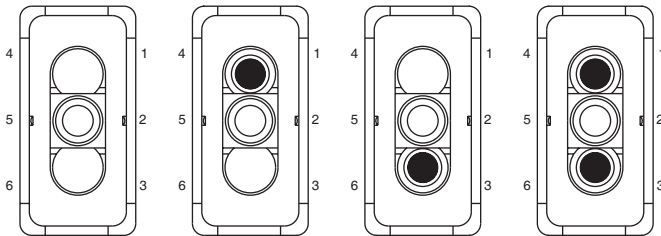

Side B

### CASE + LAMPS

### LAMP WIRING



The lamp wiring diagram is shown on the case.

To order case only (without rocker), finish your order number with the lamp wiring code.

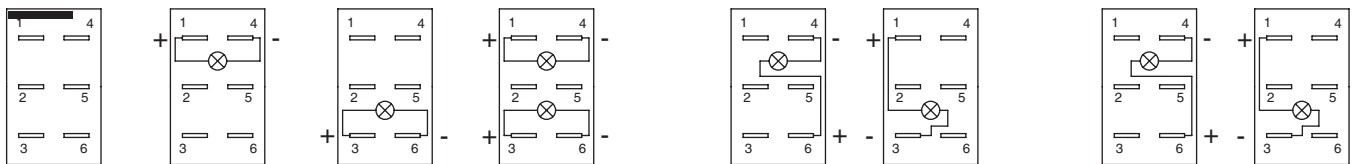

A standard

B

C

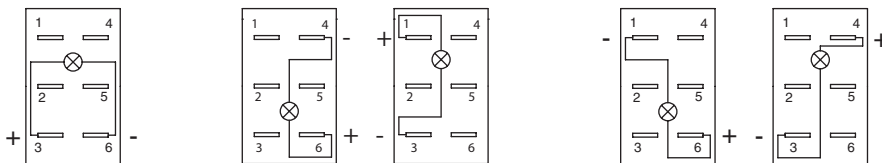

D \*

E

F

\* For function 1 (on-off) with LED on side A

Note : If not available, terminals are added to connect the LED.

# KG series

Power rocker switches

### ACTUATOR

### ROCKER COLOR



To order rocker only (without case), begin the order number with code KGR, then follow the order format from "rocker color" until the end of the options.

- |     |           |   |        |
|-----|-----------|---|--------|
| 1   | Blue      | 5 | Yellow |
| 1/4 | Dark blue | 6 | Red    |
| 2   | Black     | 7 | Ivory  |
| 3   | Green     | 9 | Orange |
| 4   | Grey      |   |        |

### ACTUATOR

### ROCKER SHAPE



- |   |                          |
|---|--------------------------|
| 1 | Full rocker              |
| 4 | Opening on side A        |
| 6 | Opening on side B        |
| 8 | Opening on sides A and B |

Other rocker shapes on customer specifications : on request.

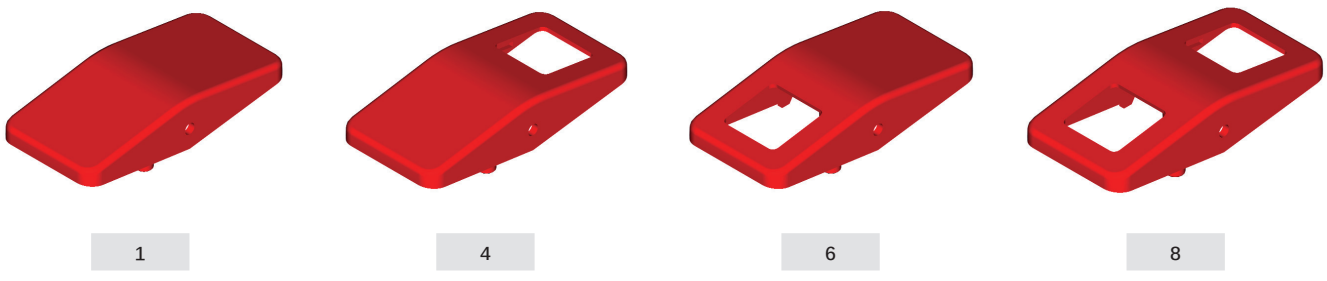

### ACTUATOR

### LENS COLOR



To order lenses only, begin the order number with the codes : KGLA for lens A and KGLB for lens B, then follow the order format from "lens color" until the end of the options.

Complete each enlarged box with one of the codes listed below.

- |   |             |
|---|-------------|
| X | No lens     |
| 1 | Blue *      |
| 3 | Green *     |
| 6 | Red         |
| 9 | Orange      |
| B | White       |
| T | Translucent |

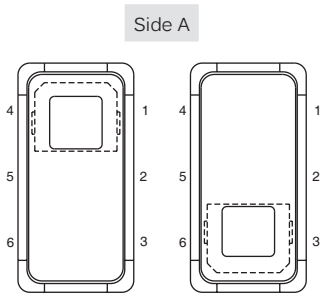
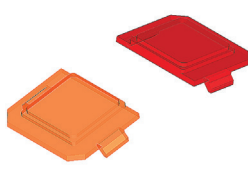

\* Blue or green lens recommended with fluorescent lamp.

4006-022-002

# KG series

Power rocker switches

## ACTUATOR

## MARKING



If no marking required, leave box blank.

Marking by hot stamping

Other orientations : on request

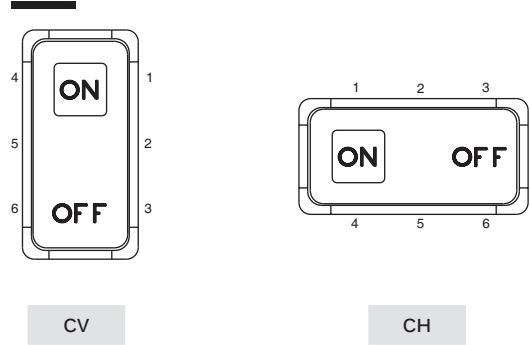

## ACTUATOR

## SYMBOLS



XX No symbol

If no marking required, end up the part number with Actuator marking orientation (see above)

### Available symbols

Complete each enlarged box with the one of the codes listed on the following pages.

### Marking color

White marking for black rockers - Black marking for color rockers

### Marking area

For illuminated versions. The symbol will be included in the hatched area.

